

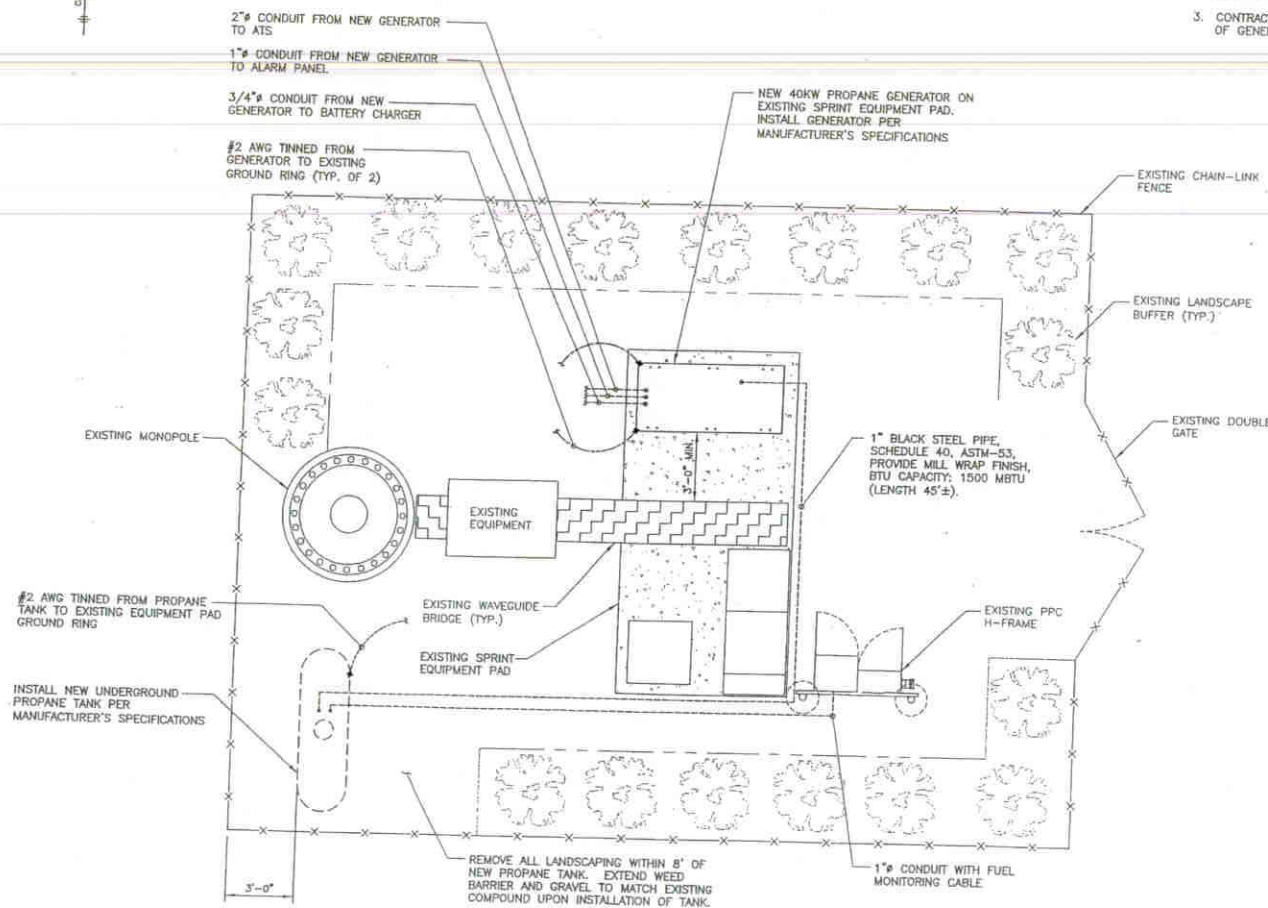

SCALE 1" = 5' (11" x 17")  
SCALE 1" = 2.5' (24" x 36")



1. NEW GENERATOR TO BE SUPPLIED BY NEXTEL AND INSTALLED BY CONTRACTOR.
2. CONNECTION TO GENERATOR WILL BE: POWER, START CIRCUIT, ALARM CIRCUIT, AND BATTERY CHARGER CIRCUIT.
3. CONTRACTOR TO COORDINATE COMMISSIONING OF GENERATOR WITH NEXTEL.

**NEXTEL**  
NEXTEL COMMUNICATIONS  
851 TRAFALGAR CT. EAST  
MANTLAND, FL 32751  
OFFICE: (407) 838-5417  
FAX: (407) 838-5408

**VCI** Group, Inc.  
1101 N. LAKE DESTINY RD.  
SUITE 130  
MANTLAND, FL 32751  
OFFICE: (407) 844-0087  
FAX: (407) 844-0090

PREPARED BY:  
**AW Solutions**  
INCORPORATED  
300 CROWN OAK CENTRE DRIVE  
LONGWOOD, FL 32750  
TEL: 407.260.0231  
FAX: 407.260.0749  
FL CO# 26983

PROJECT NO: 100.028  
DRAWN BY: PRD  
CHECKED BY: J.D.

REV	DATE	DESCRIPTION
0	5/21/06	ISSUED FOR CONSTRUCTION
A	5/19/06	ISSUED FOR REVIEW

*[Signature]*  
AUG 22 2006  
GREGORY ALAN JOHNSON  
FL P.E. #37753

IT IS A VIOLATION OF LAW FOR ANY PERSON UNLESS THEY ARE ACTING UNDER THE DIRECTION OF A LICENSED PROFESSIONAL ENGINEER TO ALTER THIS DOCUMENT UNLESS EXPLICITLY AGREED TO BY AN INDIVIDUAL IN WRITING. ANY ALTERATIONS WILL BE AT THE USER'S RISK AND ASSUME ALL LIABILITY ASSOCIATED WITH THE PROJECT. ALTERATIONS OR MODIFICATIONS OF THE CONTENTS HEREIN.

SPRINT SITE # M03XC158  
BOCA RATON HIGH SCHOOL  
1501 NW 15TH CT.  
BOCA RATON, FL 33486

SHEET TITLE  
SITE  
PLAN

SHEET NUMBER  
**E2**

100 40 25 64 18

# ELECTRICAL CONSTRUCTION SPECIFICATIONS

1. SCOPE: PROVIDE LABOR, MATERIALS, AND EQUIPMENT, ETC., REQUIRED TO COMPLETE THE INSTALLATION SHOWN ON THE DRAWINGS.
2. CODES AND STANDARDS: INSTALLATION SHALL COMPLY WITH APPLICABLE LAWS AND ORDINANCES, UTILITY COMPANY REGULATIONS AND APPLICABLE REQUIREMENTS OF LATEST EDITIONS OF:
  - A. FBC - FLORIDA BUILDING CODE
  - B. UL - UNDERWRITERS LABORATORIES
  - C. NEC - NATIONAL ELECTRICAL CODE
  - D. NEMA - NATIONAL ELECTRICAL MANUFACTURERS ASSOCIATION
  - E. OSHA - OCCUPATIONAL SAFETY AND HEALTH ACT
  - F. NESC - NATIONAL ELECTRICAL SAFETY CODE
  - G. NFPA - NATIONAL FIRE PROTECTION ASSOCIATION - CODE 58
3. PERMITS: OBTAIN AND PAY FOR REQUIRED PERMITS, LICENSES, FEES, INSPECTIONS, ETC.
4. COORDINATION: COORDINATE WORK WITH OTHER TRADES.
5. SUBMITTALS: SUBMIT BROCHURES FOR APPROVAL ON MAJOR SYSTEM COMPONENTS.
6. EXISTING SERVICES: DO NOT INTERRUPT EXISTING SERVICES WITHOUT WRITTEN PERMISSION OF THE OWNER.
7. EQUIPMENT: CONNECT ELECTRICALLY OPERATED EQUIPMENT.
8. RECORD DRAWINGS: MAINTAIN A RECORD OF ALL CHANGES, SUBSTITUTIONS BETWEEN WORK AS SPECIFIED AND INSTALLED. RECORD CHANGES ON A CLEAN SET OF CONTRACT DOCUMENTS WHICH SHALL BE TURNED OVER TO THE CONSTRUCTION MANAGER UPON COMPLETION OF THE PROJECT.
9. IDENTIFICATION: IDENTIFY SERVICE DISCONNECTION MEANS WITH PERMANENT NAMEPLATE.
10. GUARANTEE/WARRANTY: GUARANTEE INSTALLATION TO BE FREE OF DEFECTS, SHORTS, GROUND, ETC., FOR A PERIOD OF ONE YEAR. FURNISH WARRANTY SO THE DEFECTIVE MATERIAL AND/OR WORKMANSHIP WILL BE REPAIRED/REPLACED IMMEDIATELY UPON NOTIFICATION AT NO COST TO THE OWNER FOR PERIOD OF WARRANTY.
11. CUTTING AND PATCHING: PROVIDE CUTTING REQUIRED TO DO THE WORK. DO NOT CUT MAJOR STRUCTURAL ELEMENTS WITHOUT APPROVAL. PATCHING SHALL BE OF QUALITY EQUAL TO AND OF MATCHING APPEARANCE OF EXISTING CONSTRUCTION.
12. DITCHING AND BACKFILL: PROVIDE FOR ALL UNDERGROUND INSTALLED CONDUIT AND/OR CABLES.
13. RACEWAYS: UNDERGROUND CONDUIT SHALL BE SCHEDULE 40 PVC CONDUIT (MEET NEMA TC2 - 1990). EXPOSED CONDUIT SHALL BE RIGID GALVANIZED STEEL CONDUIT. UNDERGROUND PVC CONDUIT SHALL TRANSITION TO RIGID GALVANIZED STEEL CONDUIT BEFORE RISING ABOVE GRADE. PLUG AND CAP EACH END OF SPARE AND EMPTY CONDUITS AND PROVIDE TWO SEPARATE PULL STRINGS - 200 LB. TEST POLYETHYLENE CORD. ALL CONDUIT BENDS SHALL BE MINIMUM OF 24" RADIUS. GRS CONDUITS WHEN SPECIFIED, SHALL MEET UL-6 FOR GALVANIZED STEEL. ALL FITTINGS SHALL BE SUITABLE FOR USE WITH THREADED RIGID CONDUIT.
14. SUPPORTS: AS REQUIRED BY THE NEC.
15. CONDUCTORS: USE 98% CONDUCTIVITY COPPER WITH TYPE XHHW-2 INSULATION, 600 VOLT, COLOR CODED. USE SOLID CONDUCTORS FOR WIRE UP TO AND INCLUDING 8 AWG. USE STRANDED CONDUCTORS FOR WIRE ABOVE 8 AWG.
16. CONNECTORS FOR POWER CONDUCTORS: USE PRESSURE TYPE INSULATED TWIST-ON CONNECTORS FOR 10 AWG AND SMALLER. USE SOLDERLESS MECHANICAL TERMINAL LUGS FOR 8 AWG AND LARGER.
17. SERVICE: 120/240V, SINGLE PHASE, 3 WIRE CONNECTION AVAILABLE FROM UTILITY COMPANY; COORDINATE AND PAY ALL FEES.
18. TELEPHONE SERVICE: PROVIDE EMPTY CONDUITS WITH PULL STRINGS AS INDICATED ON DRAWINGS.
19. PROVIDE A GROUND WIRE SIZED PER NEC IN ALL CIRCUITS OVER 20 AMPS, AND IN ALL CIRCUIT RUNS IN SEAL TIGHT CONDUITS.
20. A.I.C. RATING TO MEET OR EXCEED ACTUAL AVAILABLE FAULT CURRENT.

## GENERAL NOTES:

DIMENSIONS SHOWN ARE APPROXIMATE. EXACT DIMENSIONS MAY BE MODIFIED SLIGHTLY BASED ON EXACT EQUIPMENT OBTAINED, SITE CONDITIONS AND OWNER PREFERENCES.

A MINIMUM OF 3'-0" DEEP X 2'-6" WIDE X 6'-0" HIGH WORKING SPACE CLEARANCE SHALL BE PROVIDED AT FRONT OF ANY ACCESS TO LIVE PARTS IN ELECTRICAL EQUIPMENT AND AS REQUIRED BY THE NEC, THE LOCAL UTILITY COMPANY AND AHJ.

POWER EQUIPMENT SHALL BE SQUARE D, SIEMENS, CUTLER-HAMMER OR GENERAL ELECTRIC. ALL EQUIPMENT MUST BE OF ONE MANUFACTURER.

UNUSED CONDUITS SHALL BE SEALED TO PREVENT MOISTURE INSIDE CONDUITS. UNUSED CONDUITS SHALL BE SEALED AFTER SERVICES HAVE BEEN RUN (IN METER CENTER, TELCO ENCLOSURE AND CARRIER EQUIPMENT).

## GENERAL NOTES CONT'D:

ALL CABINETS AND ENCLOSURES TO BE MOUNTED USING PRE-DRILLED HOLES FROM MANUFACTURER, MIN. OF (4) BOLTS PER CABINET. INSTALL PER MANUFACTURER'S SPECIFICATIONS.

ELECTRICAL SERVICE SHALL BE RATED 200A, 2 POLE, 120/240V, 1Ø 3W.

CONTRACTOR TO VERIFY UTILITY CO. FAULT CURRENT AND ENSURE THAT ALL EQUIPMENT MEETS FAULT CURRENT. (AT A MIN. ALL EQUIPMENT TO BE 10,000 AIC).

FOR COMPLETE INTERNAL WIRING AND ARRANGEMENT REFER TO VENDOR PRINTS PROVIDED BY PPC MANUFACTURER.

## GENERAL NOTES CONT'D:

ALL CONDUIT INSTALLED ABOVE GROUND LEVEL TO BE RGS. CONTRACTOR SHALL TRANSITION RGS AT ELBOW LOCATION TO PVC UNDERGROUND.

LABEL ALL BREAKERS.

**NEXTEL**

NEXTEL COMMUNICATIONS  
851 TRAVELER CT. EAST  
MARTLAND, FL 32751  
OFFICE: (407) 838-5417  
FAX: (407) 838-5400

**VCI**

Group, Inc.

1101 N. LAKE DESTINY RD.  
SUITE 130  
MARTLAND, FL 32751  
OFFICE: (407) 844-0087  
FAX: (407) 844-0086

PREPARED BY:

**AW Solutions**  
INCORPORATED

300 CROWN OAK CENTRE DRIVE  
LONGWOOD, FL 32750  
TEL: 407.260.0231  
FAX: 407.260.0749  
FL CDA# 265853

PROJECT NO: 100.028

DRAWN BY: PRD

CHECKED BY: JD

REV	DATE	DESCRIPTION
0	8/21/06	ISSUED FOR CONSTRUCTION
A	8/16/06	ISSUED FOR REVIEW

REV DATE DESCRIPTION

  
**AUG 22 2006**  
GREGORY ALAN JOHNSON  
FL P.E. #57783

IT IS A VIOLATION OF LAW FOR ANY PERSON UNLESS THEY ARE ACTING UNDER THE DIRECTION OF A LICENSED PROFESSIONAL ENGINEER TO ALTER THIS DOCUMENT. VIOLATES EXPLICITLY ISSUED BY AW SOLUTIONS IN VIOLATION OF FLORIDA STATUTE, SECTION 320.01, WHICH PROVIDES THAT ANY PERSON WHO ALTERS, ADDS TO, OR REMOVES ANY PART OF A PROFESSIONAL ENGINEER'S OR ARCHITECT'S DRAWING OR SPECIFICATION WITHOUT THE WRITTEN PERMISSION OF THE ENGINEER OR ARCHITECT IS SUBJECT TO A FINE OF UP TO \$5,000 AND/OR IMPRISONMENT FOR UP TO 5 YEARS.

SPRINT SITE # M103XC158  
BOCA RATON HIGH SCHOOL  
1501 NW 15TH CT.  
BOCA RATON, FL 33486

SHEET TITLE  
GENERAL  
NOTES

SHEET NUMBER

E1



# Attachment "B"

Two Pages

## LEASE SITE LEGAL DESCRIPTION:

A PORTION OF PART 2 OF BOCA COMMUNITY HIGH SCHOOL AS SAID PART 2 IS DESCRIBED IN A SURVEY PREPARED BY BURDETTE & ASSOCIATES ON AUGUST 29, 1995, SHEETS 1 THROUGH 7 OF 7, SAID SITE ALSO BEING A PORTION OF SECTION 13, TOWNSHIP 47 SOUTH, RANGE 42 EAST, PALM BEACH COUNTY, FLORIDA AND BEING MORE PARTICULARLY DESCRIBED AS FOLLOWS:

COMMENCE AT THE NORTHWEST CORNER OF LOT 1, BLOCK 30, COUNTRY CLUB VILLAGE SECTION E, AS RECORDED IN PLAT BOOK 28, PAGE 204 OF THE PUBLIC RECORDS OF PALM BEACH COUNTY, FLORIDA, SAID NORTHWEST CORNER ALSO BEING A POINT ON THE SOUTHERLY RIGHT-OF-WAY LINE OF THE LAKE WORTH DRAINAGE DISTRICT CANAL L-46 AND THE NORTHEAST CORNER OF PART 1 OF THE PREVIOUSLY DESCRIBED BOCA COMMUNITY HIGH SCHOOL; THENCE NORTH 88°46'40" WEST, ALONG SAID SOUTHERLY RIGHT-OF-WAY LINE AND ALONG THE NORTH LINE OF SAID PART 1, A DISTANCE OF 796.48 FEET, TO THE NORTHWEST CORNER OF SAID PART 1 AND A POINT ON THE EASTERLY RIGHT-OF-WAY LINE OF INTERSTATE 95 ACCORDING TO THE FLORIDA DEPARTMENT OF TRANSPORTATION RIGHT-OF-WAY MAP FOR SECTION 93220-2411, SHEETS 12 THROUGH 14 OF 17; THENCE NORTH 22°37'44" EAST, ALONG SAID EASTERLY RIGHT-OF-WAY LINE OF INTERSTATE 95, A DISTANCE OF 35.25 FEET; THENCE NORTH 44°04'54" EAST, CONTINUING ALONG SAID EASTERLY RIGHT-OF-WAY LINE, A DISTANCE OF 91.65 FEET, TO THE SOUTHWEST CORNER OF THE PREVIOUSLY DESCRIBED PART 2 AND A POINT ON THE NORTHERLY RIGHT-OF-WAY LINE OF SAID LAKE WORTH DRAINAGE DISTRICT CANAL L-46; THENCE CONTINUE NORTH 44°04'54" EAST, ALONG SAID EASTERLY RIGHT-OF-WAY LINE, A DISTANCE OF 154.66 FEET; THENCE SOUTH 88°58'55" EAST, DEPARTING SAID EASTERLY RIGHT-OF-WAY LINE, A DISTANCE OF 37.89 FEET, TO THE POINT OF BEGINNING OF THE FOLLOWING DESCRIBED PARCEL:

THENCE NORTH 01°01'05" EAST, A DISTANCE OF 30.00 FEET; THENCE SOUTH 88°58'55" EAST, A DISTANCE OF 40.00 FEET; THENCE SOUTH 01°01'05" WEST, A DISTANCE OF 30.00 FEET; THENCE NORTH 88°58'55" WEST, A DISTANCE OF 40.00 FEET, TO THE POINT OF BEGINNING.

CONTAINING 1.200 SQUARE FEET OR 0.275 ACRES MORE OR LESS.

## PROPOSED 20 FOOT INGRESS/EGRESS EASEMENT TO LEASE SITE:

A 20 FOOT WIDE STRIP FOR INGRESS/EGRESS EASEMENT PURPOSES, SAID STRIP BEING A PORTION OF PART 2 OF BOCA COMMUNITY HIGH SCHOOL AS SAID PART 2 IS DESCRIBED IN A SURVEY PREPARED BY BURDETTE & ASSOCIATES ON AUGUST 29, 1995, SHEETS 1 THROUGH 7 OF 7, SAID STRIP ALSO BEING A PORTION OF SECTION 13, TOWNSHIP 47 SOUTH, RANGE 42 EAST, PALM BEACH COUNTY, FLORIDA; THE PROPOSED 20 FOOT WIDE STRIP LYING 10 FEET ON EACH SIDE OF THE FOLLOWING DESCRIBED CENTERLINE:

COMMENCE AT THE NORTHWEST CORNER OF LOT 1, BLOCK 30, COUNTRY CLUB VILLAGE SECTION E, AS RECORDED IN PLAT BOOK 28, PAGE 204 OF THE PUBLIC RECORDS OF PALM BEACH COUNTY, FLORIDA, SAID NORTHWEST CORNER ALSO BEING A POINT ON THE SOUTHERLY RIGHT-OF-WAY LINE OF THE LAKE WORTH DRAINAGE DISTRICT CANAL L-46 AND THE NORTHEAST CORNER OF PART 1 OF THE PREVIOUSLY DESCRIBED BOCA COMMUNITY HIGH SCHOOL; THENCE NORTH 88°46'40" WEST, ALONG SAID SOUTHERLY RIGHT-OF-WAY LINE AND ALONG THE NORTH LINE OF SAID PART 1, A DISTANCE OF 796.48 FEET, TO THE NORTHWEST CORNER OF SAID PART 1 AND A POINT ON THE EASTERLY RIGHT-OF-WAY LINE OF INTERSTATE 95 ACCORDING TO THE FLORIDA DEPARTMENT OF TRANSPORTATION RIGHT-OF-WAY MAP FOR SECTION 93220-2411, SHEETS 12 THROUGH 14 OF 17; THENCE NORTH 22°37'44" EAST, ALONG SAID EASTERLY RIGHT-OF-WAY LINE OF INTERSTATE 95, A DISTANCE OF 35.25 FEET; THENCE NORTH 44°04'54" EAST, CONTINUING ALONG SAID EASTERLY RIGHT-OF-WAY LINE, A DISTANCE OF 91.65 FEET, TO THE SOUTHWEST CORNER OF THE PREVIOUSLY DESCRIBED PART 2 AND A POINT ON THE NORTHERLY RIGHT-OF-WAY LINE OF SAID LAKE WORTH DRAINAGE DISTRICT CANAL L-46; THENCE CONTINUE NORTH 44°04'54" EAST, ALONG SAID EASTERLY RIGHT-OF-WAY LINE, A DISTANCE OF 154.66 FEET; THENCE SOUTH 88°58'55" EAST, DEPARTING SAID EASTERLY RIGHT-OF-WAY LINE, A DISTANCE OF 37.89 FEET, TO THE SOUTHWEST CORNER OF THE LEASE SITE; THENCE CONTINUE SOUTH 88°58'55" EAST, ALONG THE SOUTH LINE OF SAID LEASE SITE, A DISTANCE OF 40.00 FEET, TO THE SOUTHEAST CORNER OF SAID LEASE SITE; THENCE NORTH 01°01'05" EAST, ALONG THE EAST LINE OF SAID LEASE SITE, A DISTANCE OF 15.00 FEET, TO THE POINT OF BEGINNING OF SAID CENTERLINE;

THENCE SOUTH 88°58'55" EAST, A DISTANCE OF 38.79 FEET; THENCE SOUTH 01°01'05" WEST, A DISTANCE OF 71.54 FEET, TO A POINT ON A LINE PARALLEL WITH AND 17.75 FEET SOUTH OF, AS MEASURED AT RIGHT ANGLES TO THE NORTH LINE OF THE 75 FOOT WIDE FLORIDA POWER AND LIGHT RIGHT-OF-WAY, AS SAID RIGHT-OF-WAY IS DESCRIBED IN OFFICIAL RECORD BOOK 811, PAGE 240 OF SAID PUBLIC RECORDS; THENCE SOUTH 88°46'40" EAST, ALONG SAID PARALLEL LINE, A DISTANCE OF 809.37 FEET, TO A POINT ON THE EASTERLY LINE OF SAID PART 2, SAID POINT ALSO BEING A POINT ON THE WESTERLY RIGHT-OF-WAY LINE OF NORTHWEST 15TH AVENUE AND THE POINT OF TERMINATION OF SAID CENTERLINE, SAID POINT OF TERMINATION LYING NORTH 00°50'29" WEST AT A DISTANCE OF 57.29 FEET ALONG THE EASTERLY LINE OF SAID PART 2 FROM THE SOUTHEAST CORNER OF SAID PART 2.

## PROPOSED 12' WIDE UTILITY EASEMENT DESCRIPTION

COMMENCE AT THE POINT OF BEGINNING OF LEASE PARCEL AS DESCRIBED ABOVE, SAID POINT OF BEGINNING ALSO BEING THE SOUTHWEST CORNER OF SAID LEASE SITE; THENCE SOUTH 88°58'55" EAST, ALONG THE SOUTHERLY LINE OF SAID LEASE SITE, A DISTANCE OF 30.15 FEET TO THE POINT OF BEGINNING OF THE CENTERLINE OF A 12 FOOT WIDE UTILITY EASEMENT DESCRIBED AS FOLLOWS:

THENCE SOUTH 01°13'10" WEST, ALONG SAID CENTERLINE, A DISTANCE OF 30.62 FEET TO A POINT ON A LINE 15 FEET NORTHERLY OF AND PARALLEL WITH THE SOUTHERLY LINE OF PART 2 AS DESCRIBED IN THE PARENT TRACT LEGAL DESCRIPTION ABOVE AND THE POINT OF TERMINATION OF SAID CENTERLINE.

# Attachment "B"

Two Pages

## PARENT TRACT LEGAL DESCRIPTION:

A PARCEL OF LAND LYING IN SECTIONS 13 AND 24, TOWNSHIP 47 SOUTH, RANGE 42 EAST, PALM BEACH COUNTY, FLORIDA, AND BEING MORE PARTICULARLY DESCRIBED AS FOLLOWS:

### PART 1

- 1) BEGINNING AT THE NORTHWEST CORNER OF LOT 1, BLOCK 30, AS DELINEATED ON A PLAT OF SUBDIVISION ENTITLED, 'COUNTRY CLUB VILLAGE SECTION E' AS RECORDED AMONG THE LAND RECORDS OF PALM BEACH COUNTY, FLORIDA, IN PLAT BOOK 28 AT PAGE 204, AND RUNNING THENCE WITH THE OUTLINE OF SAID PLAT, AS NOW SURVEYED SOUTH 00 DEGREES 37 MINUTES 40 SECONDS EAST FOR A DISTANCE OF 312.11 FEET TO A POINT; THENCE
- 2) ALONG A CURVE TO THE RIGHT HAVING A RADIUS OF 325.00 FEET AND AN ARC LENGTH OF 68.35 FEET, BEING SUBTENDED BY A CHORD OF SOUTH 05 DEGREES 23 MINUTES 48 SECONDS WEST FOR A DISTANCE OF 68.22 FEET TO A POINT; THENCE
- 3) SOUTH 11 DEGREES 25 MINUTES 17 SECONDS WEST FOR A DISTANCE OF 246.71 FEET TO A POINT; THENCE
- 4) SOUTH 00 DEGREES 43 MINUTES 15 SECONDS WEST FOR A DISTANCE OF 290.55 FEET TO A POINT; THENCE
- 5) NORTH 89 DEGREES 16 MINUTES 45 SECONDS WEST FOR A DISTANCE OF 70.00 FEET TO A POINT; THENCE
- 6) NORTH 00 DEGREES 43 MINUTES 15 SECONDS EAST FOR A DISTANCE OF 100.00 FEET TO A POINT; THENCE
- 7) NORTH 89 DEGREES 16 MINUTES 45 SECONDS WEST FOR A DISTANCE OF 894.61 FEET TO A POINT ON THE EASTERLY RIGHT-OF-WAY LINE OF INTERSTATE 95 AS DELINEATED ON FLORIDA DEPARTMENT OF TRANSPORTATION, RIGHT OF WAY MAP, SECTION 93220-2411, SHEETS 12-14, AND RUNNING THENCE WITH THE EASTERLY RIGHT-OF-WAY LINE OF SAID INTERSTATE 95, AS NOW SURVEYED
- 8) ALONG A CURVE TO THE RIGHT HAVING A RADIUS OF 5530.25 FEET AND AN ARC LENGTH OF 173.66 FEET, BEING SUBTENDED BY A CHORD OF NORTH 05 DEGREES 52 MINUTES 37 SECONDS EAST FOR A DISTANCE OF 173.66 FEET TO A POINT; THENCE
- 9) NORTH 12 DEGREES 03 MINUTES 56 SECONDS EAST FOR A DISTANCE OF 322.00 FEET TO A POINT; THENCE
- 10) NORTH 22 DEGREES 37 MINUTES 44 SECONDS EAST FOR A DISTANCE OF 357.08 FEET TO A POINT; THENCE DEPARTING SAID RIGHT-OF-WAY LINE AND RUNNING WITH THE SOUTHERLY LINE OF LAKE WORTH DRAINAGE DISTRICT CANAL L-46
- 11) SOUTH 88 DEGREES 46 MINUTES 40 SECONDS EAST FOR A DISTANCE OF 796.48 FEET TO THE POINT OF BEGINNING.

TOGETHER WITH AND SUBJECT TO COVENANTS, EASEMENTS, AND RESTRICTION OF RECORD.

SAID PROPERTY CONTAINS 754866 SQUARE FEET, OR 17.32934 ACRES MORE OR LESS.

### PART 2

COMMENCE AT THE END OF THE 10TH, OR NORTH 22 DEGREES 37 MINUTES 44 SECONDS EAST, 357.08 FEET LINE OF THE PREVIOUSLY DESCRIBED PARCEL, AND RUNNING THENCE WITH THE AFOREMENTIONED EASTERLY RIGHT-OF-WAY LINE OF INTERSTATE 95

NORTH 22 DEGREES 37 MINUTES 44 SECONDS EAST, 35.25 FEET TO A POINT; THENCE

NORTH 44 DEGREES 04 MINUTES 54 SECONDS EAST FOR A DISTANCE OF 91.65 FEET TO THE POINT OF BEGINNING; THENCE CONTINUING WITH SAID RIGHT-OF-WAY LINE

- 1) NORTH 44 DEGREES 04 MINUTES 54 SECONDS EAST FOR A DISTANCE OF 308.08 FEET TO A POINT; THENCE
- 2) NORTH 54 DEGREES 54 MINUTES 34 SECONDS EAST FOR A DISTANCE OF 245.45 FEET TO A POINT; THENCE
- 3) ALONG A CURVE TO THE LEFT HAVING A RADIUS OF 627.00 FEET AND AN ARC LENGTH OF 437.99 FEET BEING SUBTENDED BY A CHORD OF NORTH 34 DEGREES 53 MINUTES 44 SECONDS EAST FOR A DISTANCE OF 429.14 FEET TO A POINT; THENCE
- 4) NORTH 56 DEGREES 36 MINUTES 17 SECONDS EAST FOR A DISTANCE OF 222.40 FEET TO THE SOUTH RIGHT-OF-WAY LINE OF GLADES ROAD (240' WIDE); THENCE RUNNING WITH SAID SOUTH RIGHT-OF-WAY LINE
- 5) ALONG A CURVE TO THE RIGHT HAVING A RADIUS OF 4463.66 FEET AND AN ARC LENGTH OF 352.85 FEET, BEING SUBTENDED BY A CHORD OF SOUTH 72 DEGREES 51 MINUTES 06 SECONDS EAST FOR A DISTANCE OF 352.76 FEET TO A POINT; THENCE RUNNING WITH THE WEST RIGHT-OF-WAY LINE OF N.W. 15th AVENUE (60' WIDE)
- 6) SOUTH 19 DEGREES 45 MINUTES 51 SECONDS WEST FOR A DISTANCE OF 192.25 FEET TO A POINT; THENCE
- 7) ALONG A CURVE TO THE LEFT HAVING A RADIUS OF 1462.40 FEET AND AN ARC LENGTH OF 523.09 FEET, BEING SUBTENDED BY A CHORD OF SOUTH 09 DEGREES 31 MINUTES 01 SECONDS WEST FOR A DISTANCE OF 520.31 FEET TO A POINT; THENCE
- 8) SOUTH 00 DEGREES 50 MINUTES 29 SECONDS EAST FOR A DISTANCE OF 60.78 FEET TO A POINT; THENCE DEPARTING SAID RIGHT-OF-WAY LINE AND RUNNING WITH THE NORTH LINE OF LAKE WORTH DRAINAGE DISTRICT CANAL L-46 AND THE NORTH LINE OF THE AFOREMENTIONED SECTION 24
- 9) NORTH 88 DEGREES 46 MINUTES 40 SECONDS WEST FOR A DISTANCE OF 1033.52 FEET TO THE POINT OF BEGINNING.

TOGETHER WITH AND SUBJECT TO COVENANTS, EASEMENTS, AND RESTRICTION OF RECORD.

SAID PROPERTY CONTAINS 549116 SQUARE FEET OR 12.60597 ACRES MORE OR LESS.